

SP150 Mig Welding Torch Air Cooled

Rating 180A Co2 / 150A Mixed Gases @ 60% Duty Cycle - Wire Size 0.6mm to 1.0mm

9

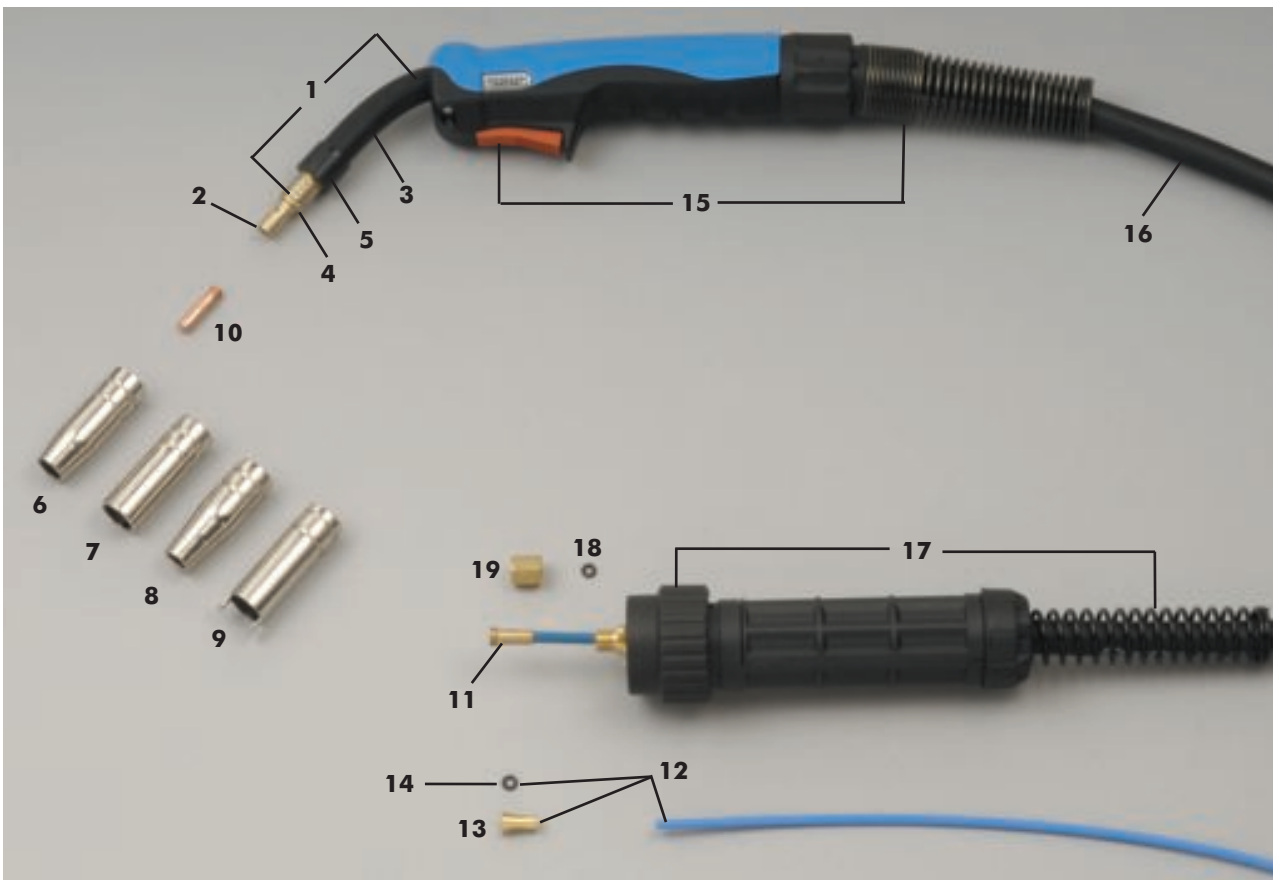

STARPARTS

TORCH PACKAGES

Item No	Length	Fitting	Switching
SP150-3ER	3mt	Euro	Microswitch
SP150-4ER	4mt	Euro	Microswitch
SP150-5ER	4mt	Euro	Microswitch
SP150-3B	3mt	Euro	Bladeswitch
SP150-4B	4mt	Euro	Bladeswitch
SP150-5B	5mt	Euro	Bladeswitch

MAIN CONSUMABLES

Item No	Part No	Description	Pack Qty
1	SP1554	Swan Neck Complete	1
2	SP1507	Tip Adaptor-Right Hand	5
3	SP1555	Insulation Sleeve	5
4	SP1557	Shroud Spring	10
5	SP1556	Insulator	5
6	SP1570	Nozzle Conical	5
7	SP1571	Nozzle Cylindrical	5
8	SP1572	Nozzle Tapered	5
9	SP1574	Spot Welding Nozzle	5

CONTACT TIPS (ECU M6 x 25mm)

10	SP1506	0.6mm Steel Wire	25
	SP1508	0.8mm Steel / 0.6mm Alum Wire	25
	SP1509	0.9mm Steel Wire	25
	SP1510	1.0mm Steel / 0.8mm Alum Wire	25
	SP1512	1.2mm Steel / 1.0mm Alum Wire	25

LINERS (Steel Plastic Coated)

11	SP1539	0.6-0.9mm x 3mt - P.C Blue	1
	SP1549	0.6-0.9mm x 4mt - P.C Blue	1
	SP1559	0.6-0.9mm x 5mt - P.C Blue	1
	SP2432	1.0-1.2mm x 3mt - P.C Red	1
	SP2442	1.0-1.2mm x 4mt - P.C Red	1
	SP2452	1.0-1.2mm x 5mt - P.C Red	1

LINERS Continued (PTFE)

Item No	Part No	Description	Pack Qty
12	SP1538T	0.6-0.8mm x 3mt - Blue	1
	SP1548T	0.6-0.8mm x 4mt - Blue	1
	SP1558T	0.6-0.8mm x 5mt - Blue	1
	SP2432T	1.0-1.2mm x 3mt - Red	1
	SP2442T	1.0-1.2mm x 4mt - Red	1
	SP2452T	1.0-1.2mm x 5mt - Red	1
13	SP1511	PTFE Liner Collet	5
14	SP1517	PTFE Liner 'O' Ring	10

SECONDARY CONSUMABLES

15	SP1613	Complete Microswitch Handle c/w Spring	1
	SP1614	Complete Bladeswitch Handle c/w Spring	1
16	SP1503	Cable Assy 3mt	1
	SP1504	Cable Assy 4mt	1
	SP1505	Cable Assy 5mt	1
17	SP8000	Complete Euro Connection Kit c/w Support	
18	SP1596	Gun Plug 'O' Ring	10
19	SP1597	Liner Retaining Nut	5