



PROTEM
A CUT ABOVE THE REST



TUBE CUTTING AND BEVELING MACHINES TTNG SERIES

- *The TT NG series pipe severing and beveling machines will sever and bevel in line pipe simultaneously.*
- *This rugged equipment is easy and safe to operate. High speed tool steel cutting bits provide accurate weld joint machining while eliminating flame cutting and grinding procedures.*
- *A variety of weld joint designs can be accomplished including square sever, double bevel, J bevel counterbore, compound bevel and socket weld removal*



FEATURES

- A variety of tool sizes for pipe severing and beveling from 2" to 78" in diameter
- Rugged, low friction bearing system
- Counterbore modules for accurate I.D. machining
- Powerful pneumatic or hydraulic drive motors
- Field adjustable bearings
- Completely enclosed drive gears for operator safety
- Adjustable clamping jaws for maintaining concentric cuts.

OPTIONS

- Electric drive
- Hydraulic drive
- Copying carriage with template
- OD tracker
- Cutting wheel
- Counterboring.

TECHNICAL SPECIFICATIONS

Capacity	From 2" to 78" (over 36" on request)
Clamping system	Split frame configuration 4 to 8 independent jaws
Tool feed	Automatic with a clutch system (remote controlled on request)
Cutting speed	Adjustable between 5 and 18 meters/mn
Motor drive	Right angle pneumatic drive 2.5 HP From TTNG 406: 2 x 2.5 HP

DIMENSIONS

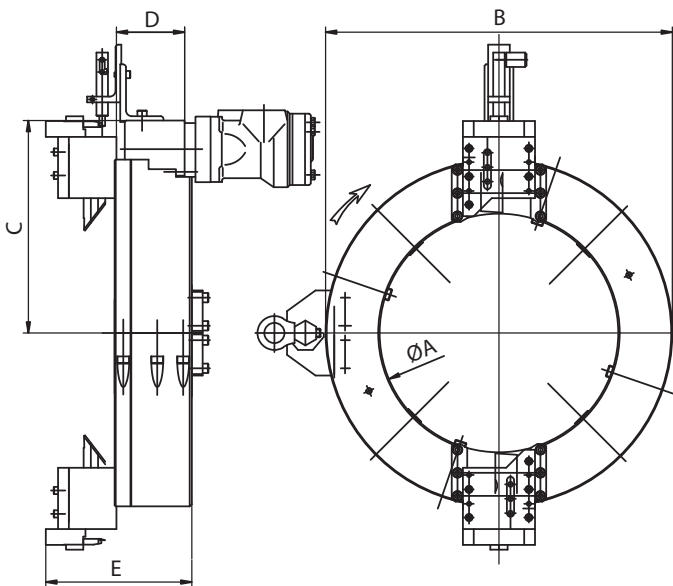

model	capacity	A mm	B mm	C mm	D mm	E mm	Weight kg
TTNG-168	2"•6"	175	325	217	107	192	34
TTNG-219	4"•8"	223	373	241	107	192	37
TTNG-273	6"•10"	283	433	271	107	192	44
TTNG-323	8"•12"	331	481	295	107	192	46
TTNG-406	10"•16"	415	565	337	107	192	51
TTNG-508	12"•20"	517	667	388	107	192	66
TTNG-610	16"•24"	619	788	448	107	192	77
TTNG-762	22"•30"	776	945	526.5	107	192	94
TTNG-900	26"•36"	925	1094	601	107	192	111
TTNG-1000	32"•40"	1016	1200	700	107	192	137
TTNG-1200	36"•48"	1262	1540	826	107	192	170
TTNG-1400	48"•56"	1460	1730	910	107	192	205

TUBE CUTTING AND BEVELING MACHINES (light weight) TTLW SERIES

■ The TTLW series machines will sever & bevel simultaneously. The light weight TTLW can be easily mounted on IN-line piping system. The TTLW is designed to be set up in tight places. The turning ring is rolling in adjustable bearings to give the possibility to be reset.

■ The TTLW can perform a cut up to 30mm wall on any material and cut & bevel on carbon steel up to 20 mm.

■ A variety of weld joint designs can be accomplished including square sever, double bevel, J bevel counter-bore, compound bevel and socket weld removal.



FEATURES

- Split frame configuration
- A variety of tool sizes from 2" up to 24"
- Rugged low friction bearing system adjustable .
- Counter bore module for accurate ID machining.
- Powerful pneumatic or hydraulic drive with complete enclosed drive gears for operator safety
- Rugged tool holders, with no adjustment to save time.
- To avoid premature wear out, the tool holder lead screw is completely enclosed
- Radial adjustable clamping jaws

OPTIONS

- Axial & radial adjustable clamping jaws
- OD tracking tool holder to follow ovalization
- Copying carriage for bevelling using single point machining.
- Counter boring tool holder
- Cutting wheel
- Electric drive
- Hydraulic drive
- Hinge
- Enveloping jaws

TECHNICAL SPECIFICATIONS

Capacity	From 2" up to 24"
Tool feed	Automatic via a clutch system Remote control on request
Cutting speed	Adjustable
Motor drive	Pneumatic / Electric or Hydraulic

DIMENSIONS

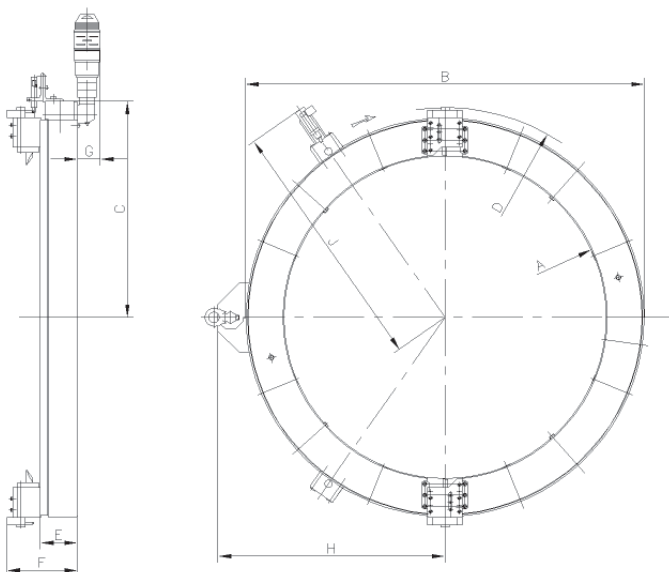

model	capacity	A mm	B mm	C mm	Ø D mm	E mm	F mm	G mm	J mm	Weight kg ⁽¹⁾
TTLW-168	2"•6"	213	313	210.7	Depending on tool holder position	82	148	80	277	14
TTLW-219	4"•8"	267	361	237.7		82	148	80	304	16.5
TTLW-273	6"•10"	321	421	264.7		82	148	80	331	19
TTLW-323	8"•12"	375	475	291.7		82	148	80	358	21.5
TTLW-406	10"•16"	459	559	333.7		82	148	80	400	25
TTLW-508	12"•20"	561	661	384.7		82	148	80	451	35
TTLW-610	16"•24"	669	769	438.7		82	148	80	505	40

(1) Without motor and tool holders

TUBE CUTTING AND BEVELING MACHINES TTSNG and TTSRD SERIES (Light weight and low-clearance)

■ The TTSNG and TTSRD machines are designed as the TTNG series to cut and/or bevel tubes and pipes in one simultaneous operation up to 15 mm WT on carbon steel.

■ The lightweight and low-clearance of those

versions allow precise machining within very restricted working areas.

■ High speed tool steel cutting bits provide accurate weld joint machining while eliminating flame cutting and grinding procedures.

■ A variety of weld joint designs can be accomplished including square sever, double bevel, J bevel counterbore, compound bevel and socket weld removal.

■ The TTSRD version are equipped with a special clamping collets system which allow a quick and auto-centering clamping pipe. That model can only cut up to 5 mm WT.



TTSRD 88

FEATURES

- Machining capacity: 1/8" to 10"
- Heavy duty, Tool holder ring gear drive
- Split frame configuration: opening in 2 half-shells.
- Field adjustable bearings
- Pneumatic, electric or hydraulic drive motors
- The feed system may be clutched and unclutched
- Completely enclosed drive gears for operator safety
- Adjustable clamping jaws for maintaining concentric cuts.

OPTIONS

- Counterboring
- TTSRD: - Clamping by collets
- Auto-centering system

TECHNICAL SPECIFICATIONS

Capacity	From 1/8" to 10" (more on request)
Clamping system	4 independent jaws for TTSNG; collets for TTSRD
Tool feed	Automatic with a clutch system
Cutting speed	Adjustable between 5 and 12 meters/mn
Motor drive	In line or right angle pneumatic drive 1HP

DIMENSIONS ⁽¹⁾

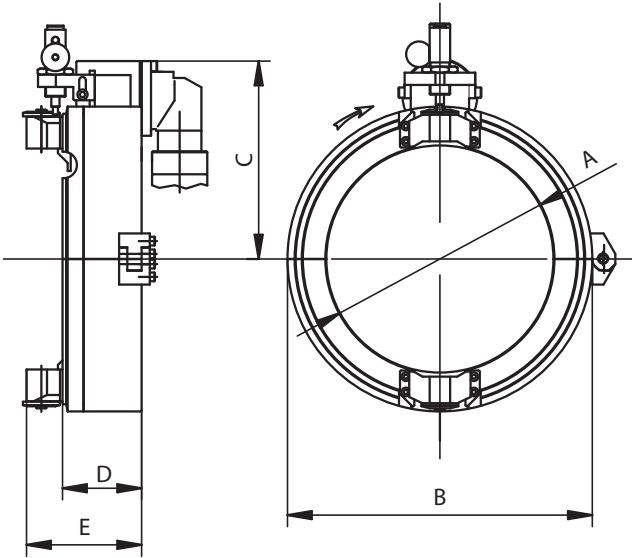

model	capacity	A mm	B mm	C mm	D mm	E mm	Weight kg
TTS NG 27	1/8" • 3/4"	30	106	99.5	59.3	126	3.5
TTS NG 33	1/8" • 1"	36	112	102.5	59.3	126	4
TTS NG 42	1/8" • 1 1/4"	45	121	107	59.3	114	4.5
TTS NG 48	1/8" • 1 1/2"	51	127	110	59.3	114	5
TTS NG 60	1/2" • 2"	63	139	116	59.3	114	5.3
TTS NG 73	1/2" • 2 1/2"	75	151	122	59.3	114	5.5
TTS NG 88	1" • 3"	90	166	129.5	59.3	114	6
TTS NG 101	1 1/2" • 3 1/2"	105	181	137	59.3	114	6.5
TTS NG 114	2" • 4"	117	193	143	59.3	114	7
TTS NG 127	2" • 4 1/2"	129	205	149	59.3	114	7.5
TTS NG 141	2 1/2" • 5"	144	220	156.5	59.3	114	8.5
TTS NG 168	3" • 6"	171	247	170	146	114	10
TTS NG 193	4" • 7"	195	271	182	158	114	11
TTS NG 219	5" • 8"	222	298	195.5	171.5	114	12
TTS NG 273	7" • 10"	276	352	222.5	59.3	114	14

(1) TTSRD: Dimensions on request.

FLANGE FACING ATTACHMENT

■ The flange facing attachment has been designed to be quickly adapted on any standard pipe bevelling machine of our range, to further multiply its use by also allowing it to resurface all the different flanges welded on pipes, directly on site,

■ Therefore we have a portable inner clamping flange facing machine to perform any geometry required by the customer; by just bringing the tool to the flange on site, where most needed.

■ One skilled operator will adapt it on our machines in a matter of minutes. Its clutch, dual side machining and different feeds will allow the operator to face damaged flanges to their original shape and with different finishes.



US150ASB

■ It may be used by clamping the machine directly inside the pipe, or if an extreme squareness and centering is required, the spider shaped elbow mandrel kit will be necessary.



US25ACC

DIMENSIONS

Machine	Minimum	Maximum	Inches
US25ACC	25 mm	300 mm	1" • 12"
US30ASB	50 mm	355 mm	2" • 14"
US40ASB	70 mm	400 mm	2"1/2 • 16"
US80ASB	100 mm	610 mm	4" • 24"
US150ASB	165 mm	900 mm	6"1-2 • 36"

OPTIONS

■ The machines have to be hydraulic driven with a 4 kW or 5.5 kW Protem power pack (version from US40ASB).



US40ASB

TUBE CUTTING AND BEVELING MACHINES TYPE MF 170 / MF 420

■ The MF series has been designed to cut and bevel tubes from 60.3 mm OD up to 406 mm OD.

The MF machine is electric driven with 3 phase motor with speed adjustment, has a fast concentric clamping device, 2 opposite tool holders fixed on the turning plate, and a safety cover to protect the operator. The machines are equipped with control box with start/stop & emergency stop buttons.

The MF machine can perform high quality welding preparation on any steel.



TECHNICAL SPECIFICATIONS

Model	MF 170	MF 420
Clamping and machining range capacity	60.3 mm up to 168 mm	168 mm up to 406 mm
Tool feed	60 mm	50 mm / 80 mm
Tool rotation	adjustable 10-80 rpm	adjustable 16-52 rpm
Weight	180 kg	500 kg
Motor drive	electric / 3 phases	electric / 3 phases
Optional equipment	cut holder	cut holder

DIMENSIONS

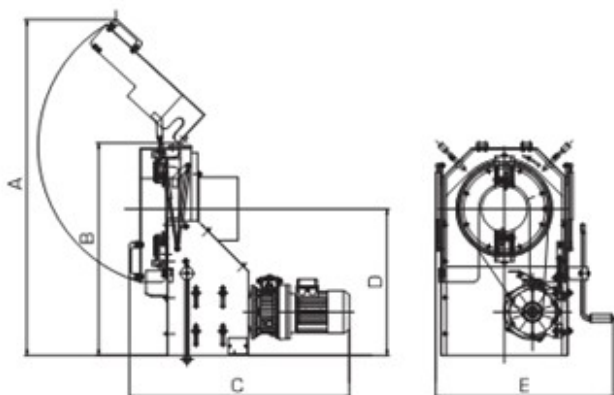

model	A (mm)	B (mm)	C (mm)	D (mm)	E (mm)
MF 170	1250	790	818	545	660
MF 420	1641	970	990	550	1010