

TUBE CUTTING AND BEVELING MACHINES (light weight) TTLW SERIES

■ The TTLW series machines will sever & bevel simultaneously. The light weight TTLW can be easily mounted on IN-line piping system. The TTLW is designed to be set up in tight places. The turning ring is rolling in adjustable bearings to give the possibility to be reset.

■ The TTLW can perform a cut up to 30mm wall on any material and cut & bevel on carbon steel up to 20 mm.

■ A variety of weld joint designs can be accomplished including square sever, double bevel, J bevel counter-bore, compound bevel and socket weld removal.



FEATURES

- Split frame configuration
- A variety of tool sizes from 2" up to 24"
- Rugged low friction bearing system adjustable .
- Counter bore module for accurate ID machining.
- Powerful pneumatic or hydraulic drive with complete enclosed drive gears for operator safety
- Rugged tool holders, with no adjustment to save time.
- To avoid premature wear out, the tool holder lead screw is completely enclosed
- Radial adjustable clamping jaws

OPTIONS

- Axial & radial adjustable clamping jaws
- OD tracking tool holder to follow ovalization
- Copying carriage for bevelling using single point machining.
- Counter boring tool holder
- Cutting wheel
- Electric drive
- Hydraulic drive
- Hinge
- Enveloping jaws

TECHNICAL SPECIFICATIONS

Capacity	From 2" up to 24"
Tool feed	Automatic via a clutch system Remote control on request
Cutting speed	Adjustable
Motor drive	Pneumatic / Electric or Hydraulic

DIMENSIONS

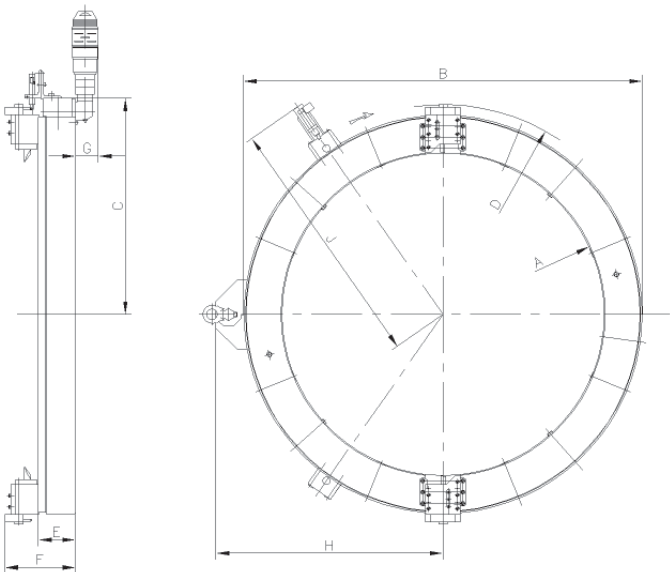

model	capacity	A mm	B mm	C mm	Ø D mm	E mm	F mm	G mm	J mm	Weight kg ⁽¹⁾
TTLW-168	2"•6"	213	313	210.7	Depending on tool holder position	82	148	80	277	14
TTLW-219	4"•8"	267	361	237.7		82	148	80	304	16.5
TTLW-273	6"•10"	321	421	264.7		82	148	80	331	19
TTLW-323	8"•12"	375	475	291.7		82	148	80	358	21.5
TTLW-406	10"•16"	459	559	333.7		82	148	80	400	25
TTLW-508	12"•20"	561	661	384.7		82	148	80	451	35
TTLW-610	16"•24"	669	769	438.7		82	148	80	505	40

(1) Without motor and tool holders